

BUCKLEY FENCE HAY FEEDER USER MANUAL





BUCKLEY
F E N C E

Thank you so much for your purchase! This manual will walk you through how to install Buckley Fence's Hay Feeder. Please do not hesitate to call us at 720-644-6884 or visit our website at www.buckleyfence.com/FAQ if you have any questions about installation.

READ AND SAVE THESE INSTRUCTIONS

U.S. Patent No. 12,082,553. Buckley Fence LLC, 6000 E. 49th Place, Suite 10, Commerce City, CO, 80022



PRODUCT STRUCTURE

WHAT'S INCLUDED WITH YOUR HAY FEEDER SHIPMENT

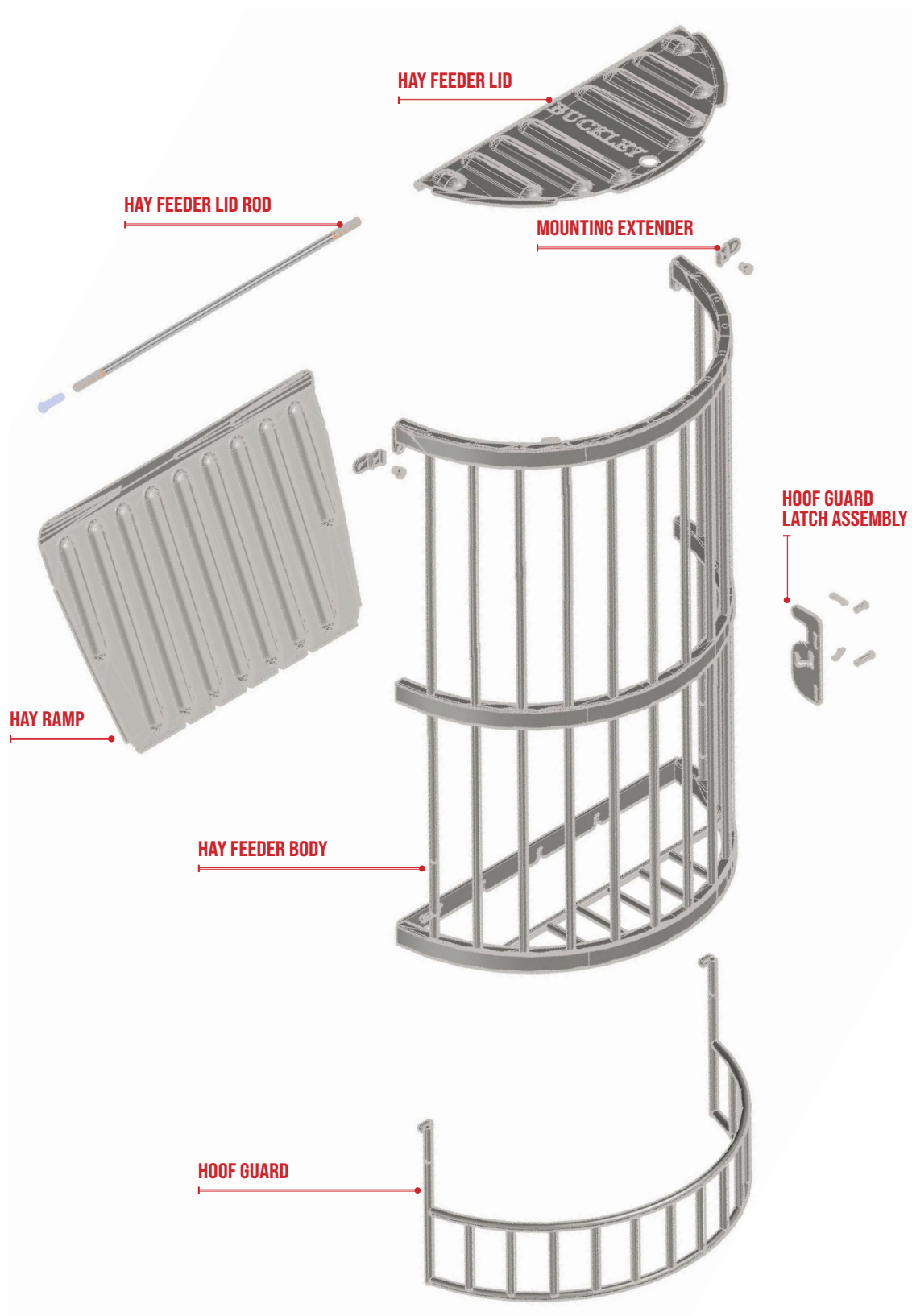



HAY FEEDER INSTALLATION

HOW TO INSTALL YOUR BUCKLEY HAY FEEDER

The Buckley Hay Feeder saves time, is easy to clean, ergonomic, safe for hooves, and ensures your high quality feed stays fresh. Plus, the horses we love get the nutrients and care they need and deserve.

REQUIRED MATERIALS

1. Drill
2. $\frac{9}{64}$ " socket
3. $\frac{1}{4}$ " drill bit
4. Level
5. Two $\frac{3}{16}$ " allen keys
6. Pliers

1 INSTALLING THE LID

1. Insert the Hay Feeder Lid Rod into the opening at the back of the Hay Feeder Lid and align with the holes on the top of the Hay Feeder Body.
2. Insert and tighten the two stainless steel bolts into the Lid Rod, attaching the Lid to the body of the Hay Feeder with two $\frac{3}{16}$ " Allen Wrenches.

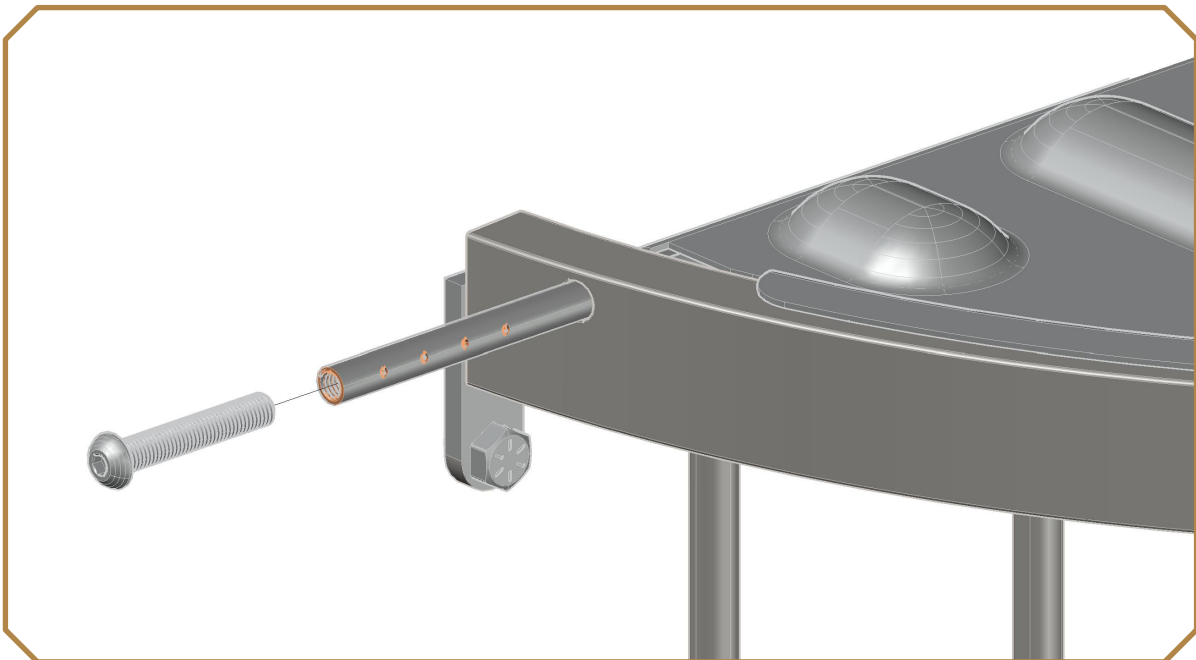

2 INSTALLING THE HOOF GUARD

1. Install the Hoof Guard Latch using the short clevis pin, washer, and cotter pin.
2. Install the Hoof Guard using the long clevis pin, washer, and cotter pin.
3. Install the opposite side of the Hoof Guard using the long clevis pin and cotter pin.

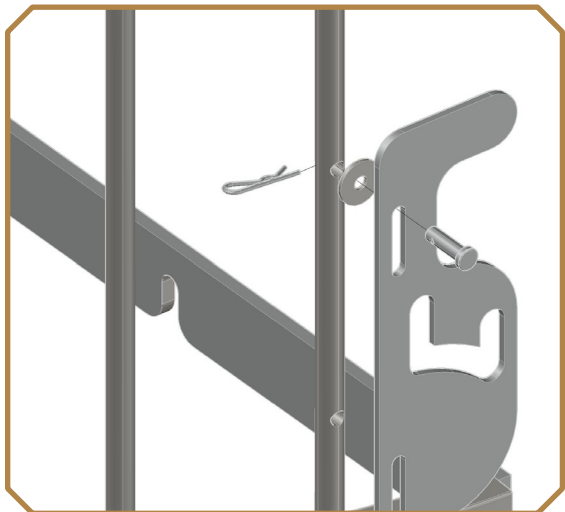

Step #1

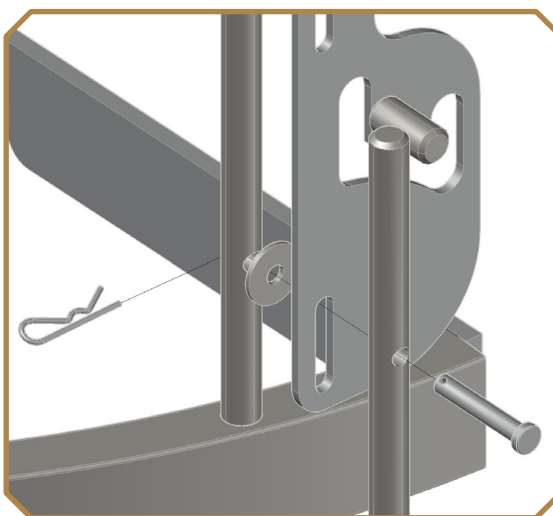

Step #2

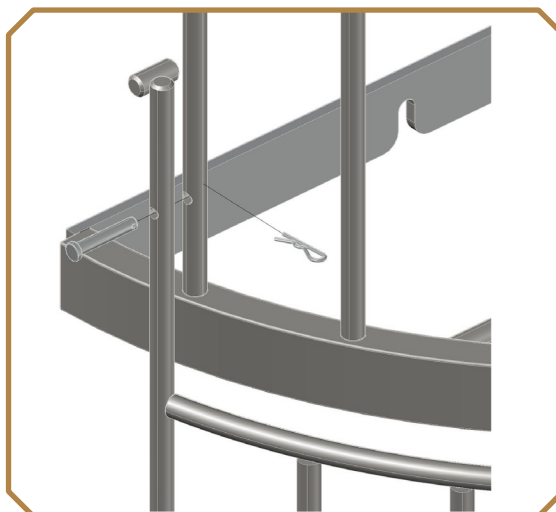

Step #3

3 MOUNTING THE HAY FEEDER BODY

The Buckley Hay Feeder must be installed in a location with a flat wall surface to keep hay from falling into the wall cavity. If installed on a wall with exposed framing, plywood or other backing must be installed behind the Hay Feeder.

1. Place the Hay Feeder in your chosen location, with the Hoof Guard 1" - 3" off the ground, ensuring it is level. Screw through both top holes in the Hay Feeder and one or two of the slots in the bottom of the Hay Feeder, depending on stud spacing. We recommend mounting the bolts directly into studs with a $\frac{9}{16}$ " socket, and pre-drill using a $\frac{1}{4}$ " drill bit to prevent studs from cracking.
2. Optionally, the Top Mounting Extenders can be attached to the top mounting holes of the Hay Feeder to match stud placement in your location. Use the provided bolts and a $\frac{9}{16}$ " socket to attach the Extenders.

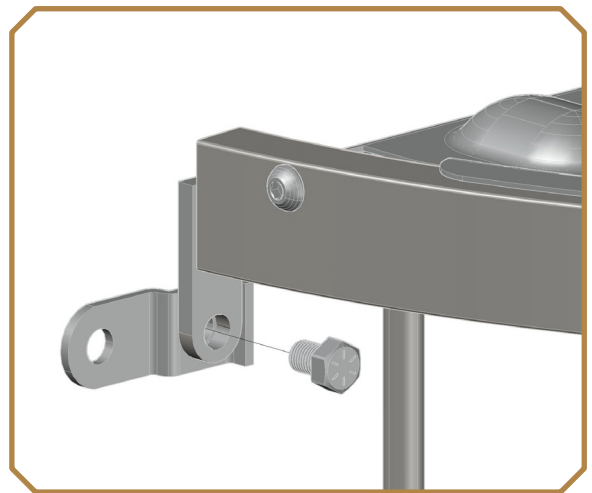
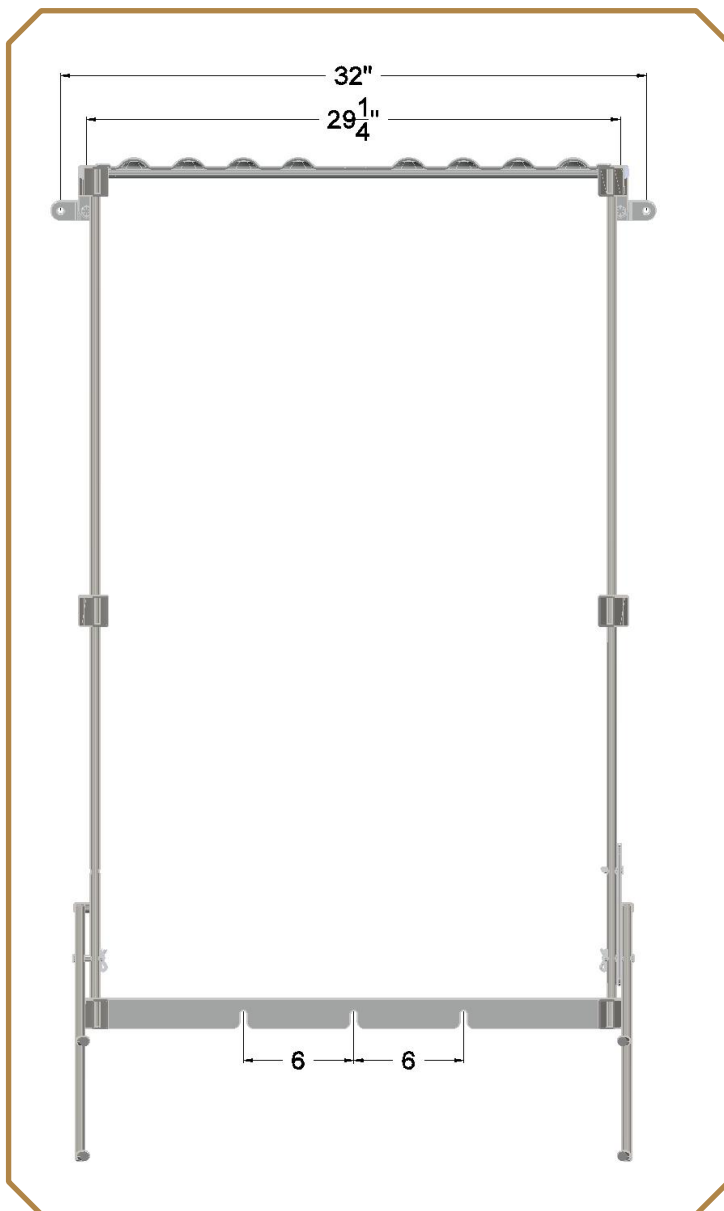

4

MOUNTING THE HAY RAMP

1. Slide the Hay Ramp between the bars of the Hay Feeder opposite the Hoof Guard Latch and lock the Hay Ramp notches to the lower bars of the Hay Feeder Body.
2. Attach the Hay Ramp to the wall with the three remaining screws and a $\frac{9}{16}$ " socket.

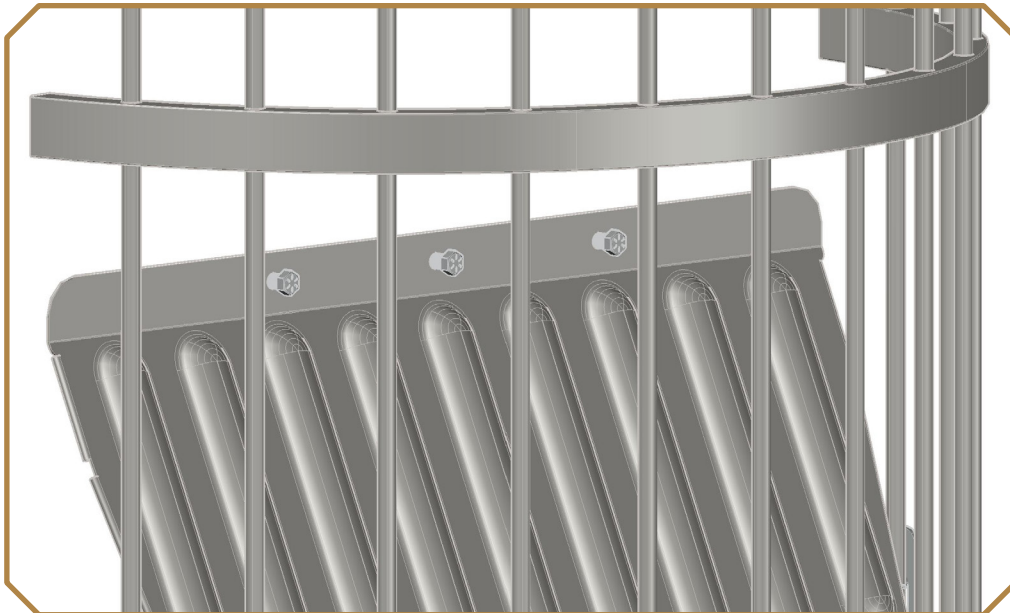
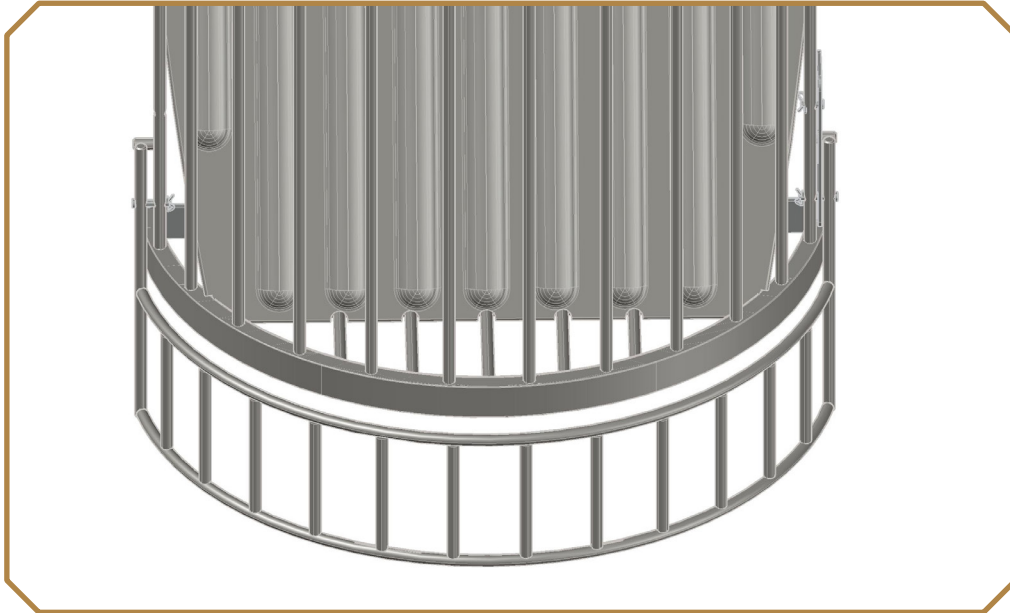



OPERATION

HOW TO USE YOUR BUCKLEY HAY FEEDER

The Buckley Hay Feeder is designed to hold ½ bale of hay at a time for your animals. Simply lift the magnetically locking lid to drop hay in, and it is pushed to the front of the Hay Feeder by the Hay Ramp.

Cleaning the Buckley Hay Feeder is simple. Lift up on the Hoof Guard Latch, raise the Hoof Guard, and allow the Hoof Guard Latch to drop to lock the Hoof Guard in the raised position. Sweep under the Hay Feeder and pull up on the Hoof Guard Latch when finished to allow the Hoof Guard to drop back into place.

The magnetic latch on the lid should automatically keep your animals from being able to open the lid. However, if the lid does not hold in place, you can adjust the magnet up by simply loosening the screws that attach to the magnet, moving the magnet latch up, and tightening the screws back into place.

This product is not intended for outdoor use.

